



Equipment for the Foodservice Industry

value + quality + service

X-LINE 25" Glass Single Door Black Cooler

Model No:

C1-25GDVCX



C1-25GDVCX

Features

Features:

- CABINET CONSTRUCTION
 - Exterior - coated steel
 - Interior - attractive, aluminum liner with stainless steel floor
- Rounded corner design inside of the cabinet makes it easy to clean the inside storage room
- Self-closing double pane glass door with positive seal, torsion type closure system
- R290 Refrigeration system holds 33°F to 41°F (0°C to 5°C)
- Adjustable temperature set point and defrost frequency
- Adjustable, heavy duty PVC coated shelves
- LED light
- "No stoop" lower shelf
- Easily accessible condenser coil for cleaning, and easy service access
- Simple installation with no plumbing required

Warranty

- Two year parts and labour; Five years on compressor. For full warranty details visit <https://www.efifoodequip.com/warranty-info.php>

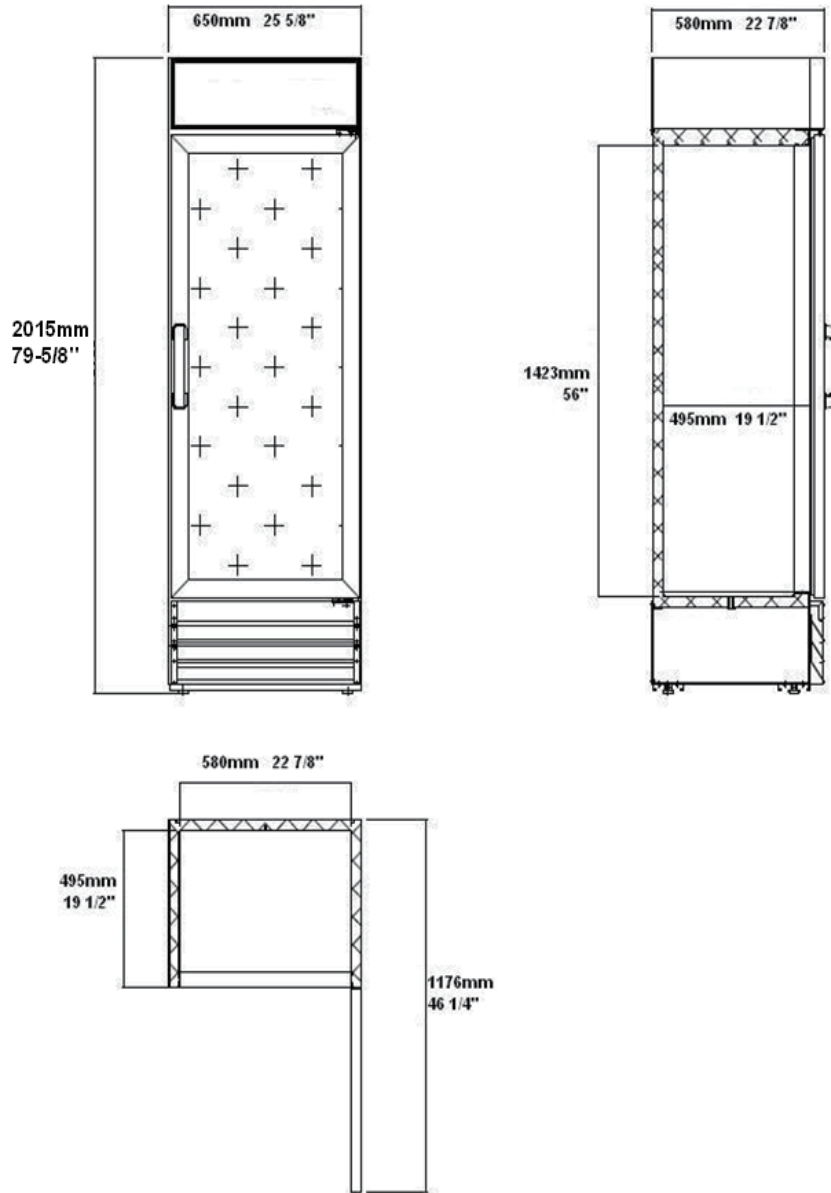

C1-25GDVCX**Specifications**

Model	Doors	Shelves	Dimension (mm) (inch)			HP	Voltage	Amps	Capacity (L) (Cu Ft.)	Net Weight (KG) (LBS)	Temperature Range	NEMA Config.
			L	D	H							
C1-25GDVCX	1	4	650	580	2015	1/4	115/60/1	2.88	398	120	0 ~ 5°C	5-15P ⓘ
			25.6	22.8	79.3				14	265	33 ~ 41°F	

Specifications subject to change without notice.