

# Howard McCray

## **MIRAGE ELITE MERCHANDISER**

### DELI & DESSERT CASE

Thermoformed Side Walls With Modern Design

Heavy Duty Condensing Unit For R-134a

Easy Access For Service

2 Rear Sliding Glass Doors

3 Levels Of Display

LED Lighting

Electronic Controls

Forced Air

Black Finish



## SIDE VIEW • PLAN VIEW

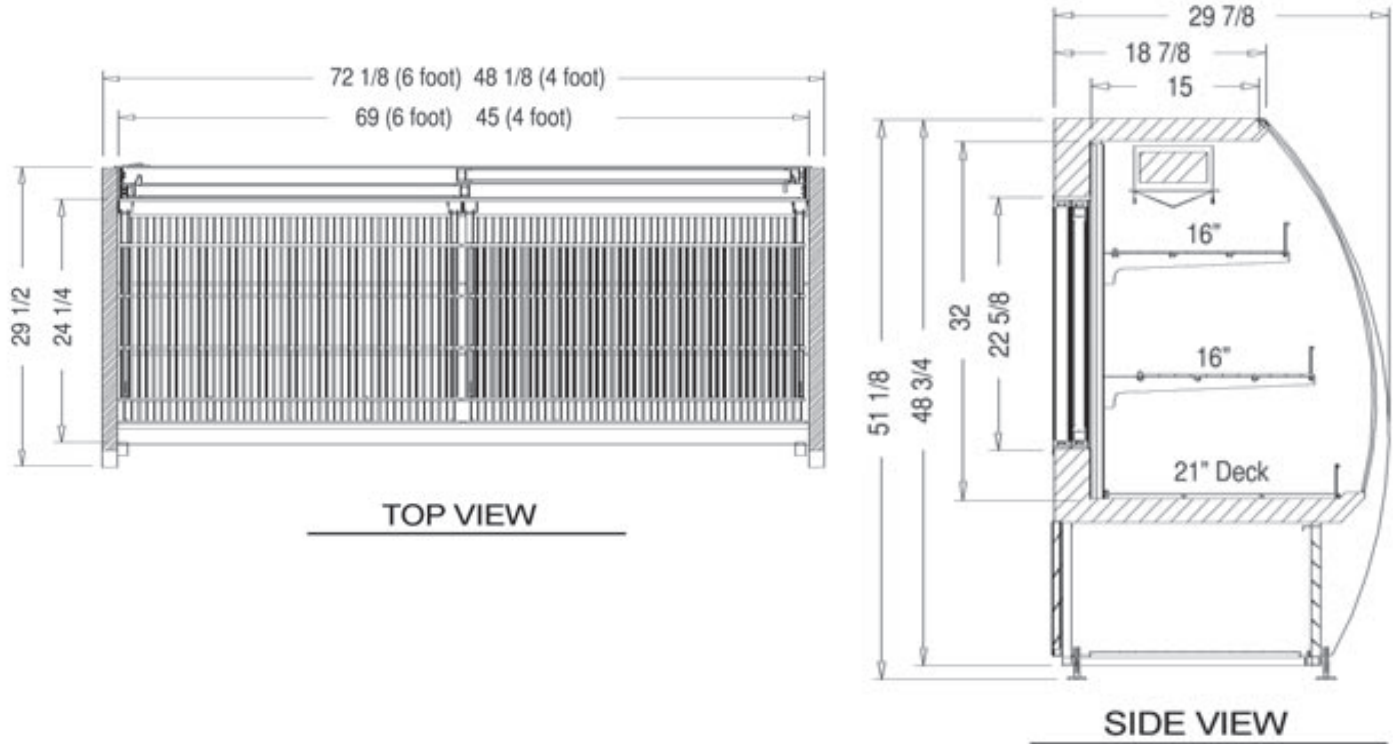

## TECHNICAL SPECIFICATIONS

MODEL	MIRAGE-ELITE-4-DC	MIRAGE-ELITE-6-DC
DIMENSIONS (H x W x D)	52 x 48 -7/16 x 29 -7/8"	52 x 72 x 29 -7/8"
Door Size	23 x 21"	34 x 21"
Door Type	2 sliding	2 sliding
Shelf Size	(6) 21 x 16"	(6) 33 x 16"
# of Shelves	6	6
Capacity: Cubic Foot	19	24
Operating Temperature	35°F to 46°F	35°F to 46°F
Refrigerant	R-134a	R-134a
Compressor Size HP	1/4	1/3
Electrical	115/60/1	115/60/1
Amperage	4.5	5.2
Cord and Plug	yes	yes
Weight (lbs.)	404	476

**Important Note:** All refrigerated cases are designed to operate in an environment of 75° and 55% relative humidity.

**Important Note:** Product must be cooled before being displayed within the case.

Specification subject to change without notice